

**DEEP 22.5-MM PUSHBUTTON ENCLOSURES, TYPE 12**

**INDUSTRY STANDARDS**

 UL 508A Listed; Type 12, 13; File No. E61997  
 cUL Listed per CSA C22.2 No. 94; Type 12, 13; File No. E61997

 NEMA/EEMAC Type 12, 13  
 CSA File Number 42186: Type 12  
 IEC 60529, IP65

**APPLICATION**

Designed for pushbuttons and switches, the extra depth of these enclosures accommodates additional pushbutton contact blocks.

**SPECIFICATIONS**

- 14 gauge steel
- Seams continuously welded and ground smooth
- Captivated cover screws thread into sealed wells
- Grounding nut in body of enclosure
- Bonding provision on cover
- Oil-resistant gasket
- Enclosures with more than one column of pushbutton holes have internal detachable hinge
- External wall-mounting brackets
- Factory stamped 4-way pushbutton holes

**FINISH**

ANSI 61 gray polyester powder paint inside and out

**ACCESSORIES**

 See also *Accessories*.  
 Industrial Corrosion Inhibitors  
 HOL-SEALERS™ Hole Seals  
 Tamper-Resistant Screws

**BULLETIN: PB1**

## Standard Product

| Catalog Number | AxBxC in./mm        | Number of Holes | Mounting G x H in./mm | Overall L x W in./mm | J in./mm | T in./mm | X in./mm | Y in./mm |
|----------------|---------------------|-----------------|-----------------------|----------------------|----------|----------|----------|----------|
| E1PBGXM        | 3.25 x 2.75 x 3.50  | 1               | 3.75 x 1.88           | 4.25 x 2.97          | 3.09     | 2.50     | 1.48     | 1.73     |
|                | 83 x 70 x 89        |                 | 95 x 48               | 108 x 75             | 78       | 64       | 38       | 44       |
| E2PBGXM        | 5.12 x 2.75 x 3.50  | 2               | 5.62 x 1.88           | 6.12 x 2.97          | 3.09     | 2.50     | 1.48     | 1.55     |
|                | 130 x 70 x 89       |                 | 143 x 48              | 155 x 75             | 78       | 64       | 38       | 39       |
| E3PBGXM        | 7.25 x 2.75 x 3.50  | 3               | 7.75 x 1.88           | 8.25 x 2.97          | 3.09     | 2.50     | 1.48     | 1.48     |
|                | 184 x 70 x 89       |                 | 197 x 48              | 210 x 75             | 78       | 64       | 38       | 38       |
| E4PBGXM        | 9.50 x 2.75 x 3.50  | 4               | 10.00 x 1.88          | 10.50 x 2.97         | 3.09     | 2.50     | 1.48     | 1.48     |
|                | 241 x 70 x 89       |                 | 254 x 48              | 267 x 75             | 78       | 64       | 38       | 38       |
| E6PBGXM        | 8.50 x 5.00 x 4.25  | 6               | 9.00 x 4.12           | 9.50 x 5.22          | 3.84     | 4.75     | 1.48     | 2.11     |
|                | 216 x 127 x 108     |                 | 229 x 105             | 241 x 133            | 98       | 121      | 38       | 54       |
| E9PBGXM        | 8.50 x 7.25 x 4.25  | 9               | 9.00 x 5.63           | 9.50 x 7.47          | 3.84     | 6.25     | 1.48     | 2.11     |
|                | 216 x 184 x 108     |                 | 229 x 162             | 241 x 190            | 98       | 159      | 38       | 54       |
| E12PBGXM       | 10.38 x 7.25 x 4.25 | 12              | 10.88 x 5.63          | 11.38 x 7.47         | 3.84     | 6.25     | 1.48     | 1.92     |
|                | 264 x 184 x 108     |                 | 276 x 162             | 289 x 190            | 98       | 159      | 38       | 49       |

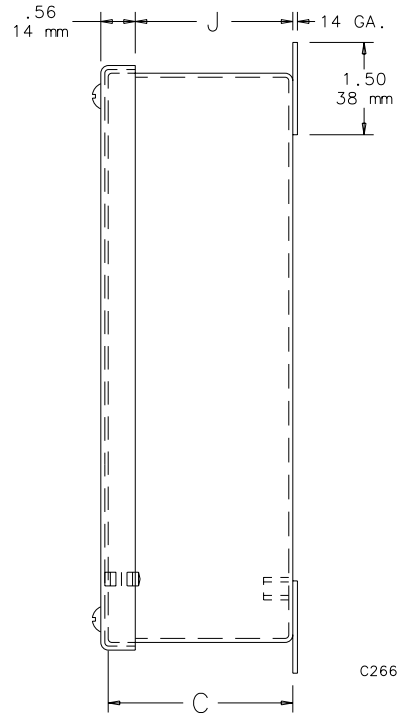
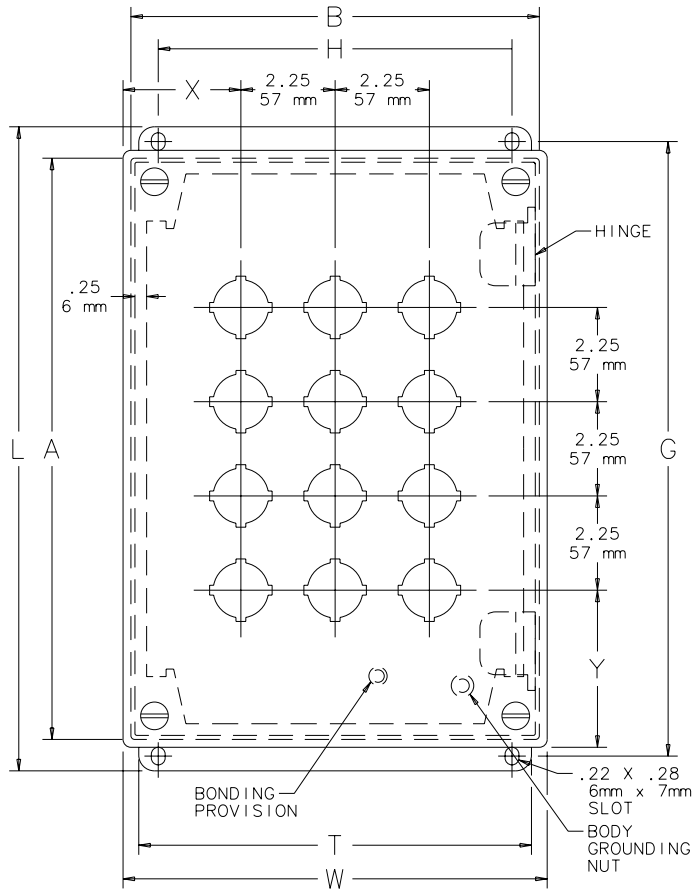

C2667-C

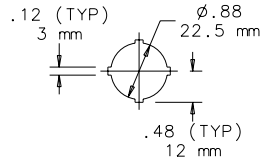

22.5mm 4-way

